



Simmonds Road | Bloxwich, Walsall | WS3 3PT
Offers Over £285,000



Summary

****MUCH IMPROVED THREE BEDROOM SEMI DETACHED HOME ** LARGE KITCHEN DINER ** IMMACULATLEY PRESENTED ** LANDSCPAED REAR GARDEN ** CANAL SIDE LOCATION** HOME OFFIE/ STUDY ** GUEST WC ** DRIVEWAY ** POPULAR LOCATION****

Webbs Estate Agents are pleased to bring to market this much improved three bedroom semi detached home. The enviable position of the garden being canal side is perfect for outdoor entreating, being within and easy reach of local amenities, including High street shops, school at nearby Bloxwich Town Centre.

In brief this home offers: Driveway to the front, porch, entrance hall, lounge, dining area, fitted breakfast kitchen, snug/office and guest WC.

On the first floor there are three generous bedrooms and family bathroom.

To the rear is a private and enclosed landscaped rear garden situated on the canal side to the back.

Call us today to view this immaculately presented family home on 01922 663399

Key Features

- THREE BEDROOM SEMI DETACHED HOME
- GARDEN HAS CANAL SIDE LOCATION
- ENVIOUS KITCHEN DINER
- GUEST WC
- LADNSCPAED REAR GARDEN
- IMMCULATLEY PRESENTED
- POPULAR RESIDENTAIL ESTATE
- DOWNSTAIRS OFFICE/SNUG
- DRIVEWAY
- CALL TODAY ON 01922 663399 TO SECURE YOUR VIEWING

Rooms and Dimensions

Porch

Hall

Lounge

15'1" x 11'10" (4.60m x 3.61m)

Dining Area

9'10" x 8'9" (3.02m x 2.67m)

Breakfast Kitchen

15'8" x 9'8" (4.78m x 2.97m)

Snug/Office

8'10" x 7'10" (2.7m x 2.4m)

Guest WC

Landing

Family Bathroom

Bedroom One

15'1" x 10'5" (4.60m x 3.18m)

Bedroom Two

10'0" x 10'0" (3.07m x 3.05m)

Bedroom Three

9'8" x 7'1" (2.95m x 2.18m)

Driveway

Rear Garden





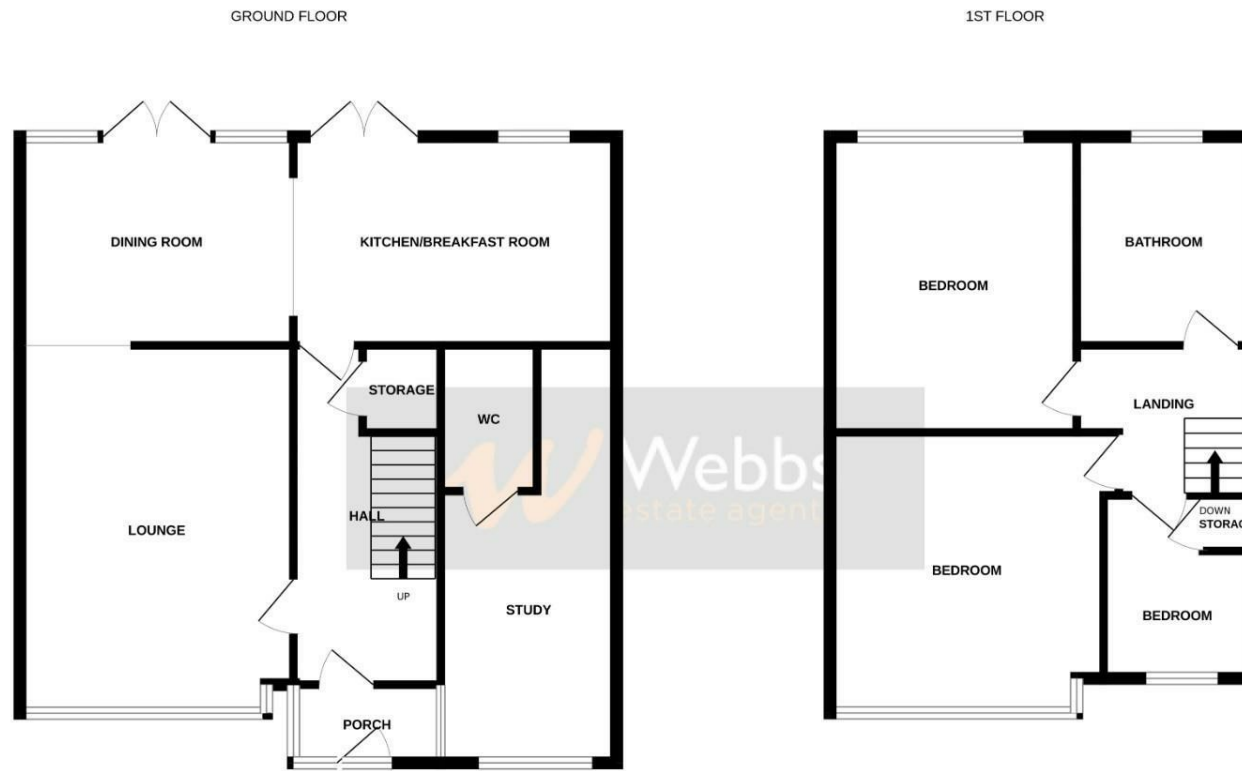

Whilst every attempt has been made to ensure the accuracy of the floorplan contained here, measurements of doors, windows, rooms and any other items are approximate and no responsibility is taken for any error, omission or mis-statement. This plan is for illustrative purposes only and should be used as such by any prospective purchaser. The services, systems and appliances shown have not been tested and no guarantee as to their operability or efficiency can be given.
Made with Metropix ©2024

Webbs Estate Agents - endeavour to maintain accurate depictions of properties in Virtual Tours, Floor Plans and descriptions, however, these are intended only as a guide and purchasers must satisfy themselves by personal inspection.

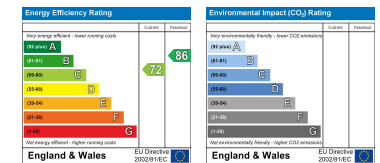

212 High Street, Bloxwich, Walsall, WS3 3LA

Tel: 01922 663399 | Email: bloxwich@webbestateagents.co.uk | www.webbestateagents.co.uk

